

REV. NO.	DATE	DESCRIPTION	APP'D	REMARKS
△	-	-	-	-

0

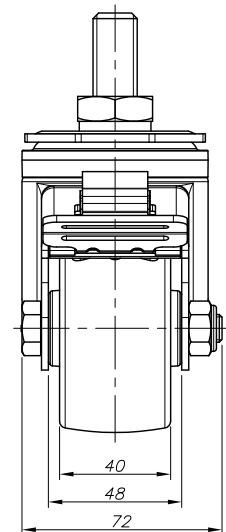
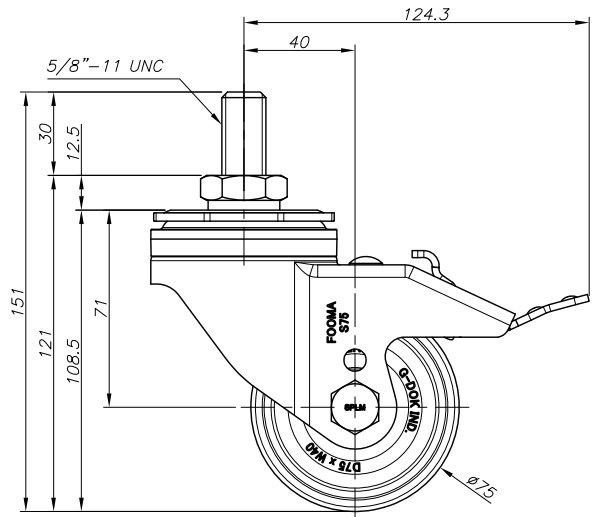
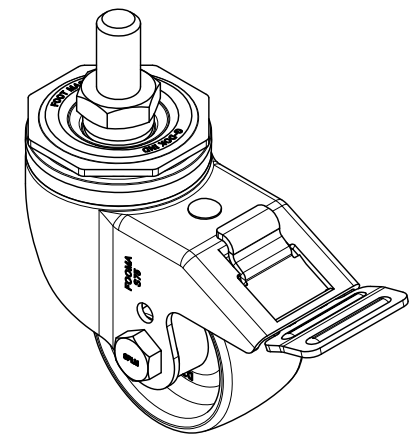
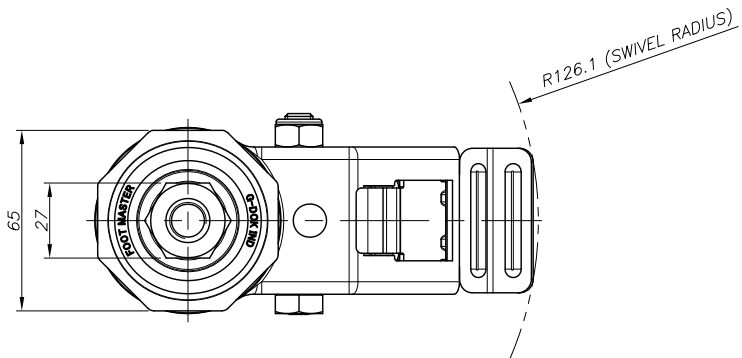

NOTE
 1) MATERIAL : STAINLESS

PROCESS	GENERAL TOLERANCE		CHAMFER	0.5	ROUND	0.5	UNIT	mm
---	---		0.5	0.5	0.5	mm		
MATERIAL	PRODUCT GENERAL TOLERANCE							
---	0.5 - 6	6 - 30	30 - 120	120 - 400	400 - 1000	0.1	0.15	0.2
APPROVED BY	CHECKED BY	DRAWN BY						
O.C.K	J.Y.H	K.S.J						

FOOT MASTER®		FOOMA®		G-DOK IND.	
SERIES NAME	SPLM-SERIES	DATE	2025.07.18	GSN NO.	39152-111111
PRODUCT NAME	SPLM-75-BSS-NYP	SCALE	1/2	DWG. NO.	39152-111111
PART NAME	ASSEMBLY	WEIGHT	--	REVISION	SIZE A3
GENERAL TOLERANCE		B	ANGLE		⊕

FOOT MASTER G-DOK IND.

REV. NO.	DATE	DESCRIPTION	APP'D	REMARKS
△	-	-	-	-

0

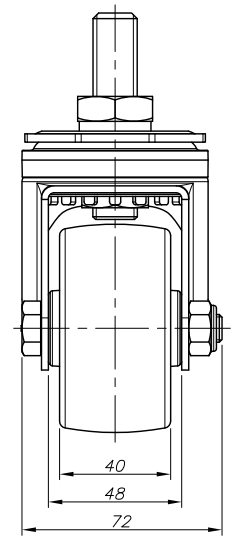
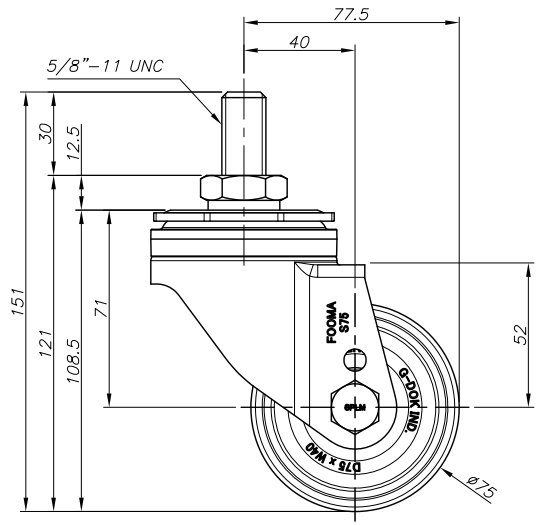
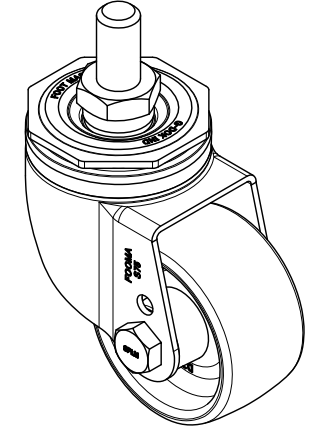
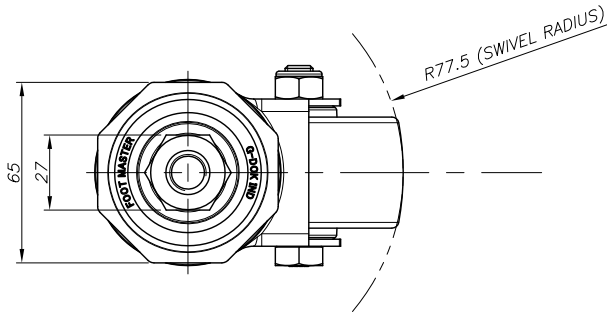

NOTE
 1) MATERIAL : STAINLESS

PROCESS	GENERAL TOLERANCE															
MATERIAL	MACHINING WORKING				DIE CASTINGS				INJECTION MOLDING				PRESS WORKING			
	ANGZ	PRECISION	GRADE	UNIT	ANGZ	PRECISION	GRADE	UNIT	ANGZ	PRECISION	GRADE	UNIT	ANGZ	PRECISION	GRADE	UNIT
	0.5 - 6	±0.05	±0.1	mm	0.5 - 6	±0.1	±0.2	mm	0.5 - 6	±0.1	±0.2	mm	0.5 - 6	±0.1	±0.2	mm
	6 - 30	±0.1	±0.2	mm	6 - 30	±0.2	±0.3	mm	6 - 30	±0.2	±0.3	mm	6 - 30	±0.2	±0.3	mm
	30 - 120	±0.15	±0.3	mm	30 - 120	±0.3	±0.4	mm	30 - 120	±0.3	±0.4	mm	30 - 120	±0.3	±0.4	mm
	120 - 400	±0.2	±0.5	mm	120 - 400	±0.4	±0.6	mm	120 - 400	±0.4	±0.6	mm	120 - 400	±0.4	±0.6	mm
	400 - 1000	±0.3	±0.8	mm	400 - 1000	±0.5	±1.0	mm	400 - 1000	±0.5	±1.0	mm	400 - 1000	±0.5	±1.0	mm

FOOT MASTER®		FOOMA®		G-DOK IND.	
SERIES NAME	SPLM-SERIES	DATE	2025.07.18	GSN NO.	39142-111111
PRODUCT NAME	SPLM-75-ASS-NYP	SCALE	1/2	DWG. NO.	39142-111111
PART NAME	ASSEMBLY	WEIGHT	--	REVISION	SIZE A3
GENERAL TOLERANCE		B	ANGLE		⊕

FOOT MASTER G-DOK IND.

REV. NO.	DATE	DESCRIPTION	APP'D	REMARKS
△	-	-	-	-

0

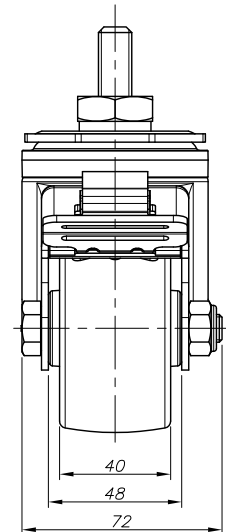
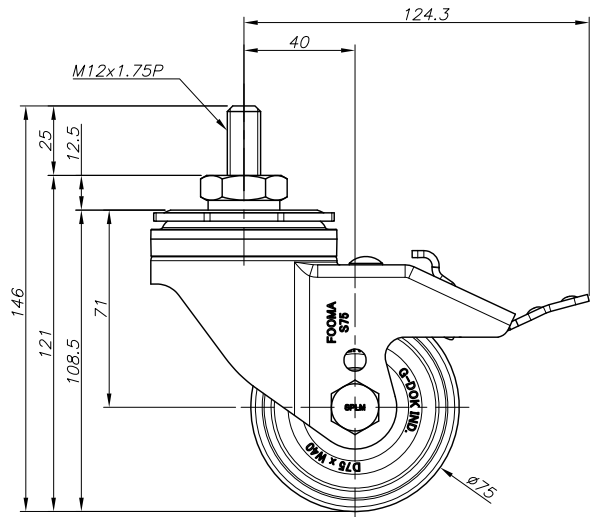
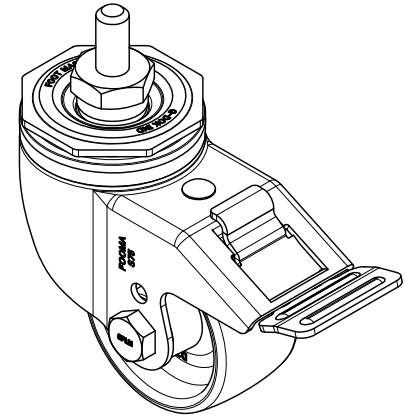
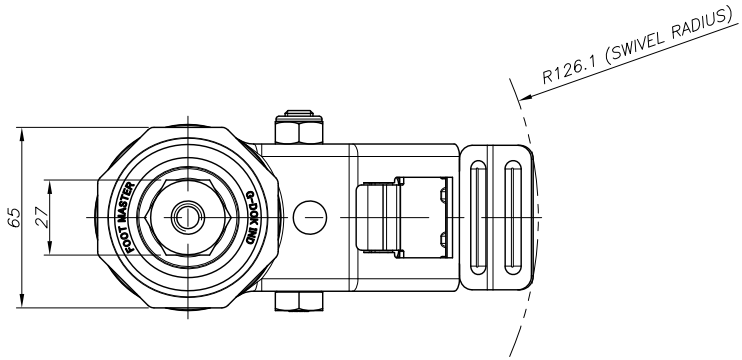

NOTE
 1) MATERIAL : STAINLESS

PROCESS	---																																																																
MATERIAL	---																																																																
<table border="1"> <thead> <tr> <th colspan="2">GENERAL TOLERANCE</th> <th>CHAMFER</th> <th>0.5</th> <th>ROUND</th> <th>0.5</th> <th>UNIT</th> <th>mm</th> </tr> <tr> <th>MACHINING WORKING</th> <th>DIE CASTING</th> <th colspan="2">INJECTION MOLDING</th> <th colspan="2">PRESS WORKING</th> <th></th> <th></th> </tr> <tr> <th>FINISH</th> <th>PRECISION</th> <th>GRADE</th> <th>FINISH</th> <th>PRECISION</th> <th>GRADE</th> <th></th> <th></th> </tr> <tr> <th>0.5 - 6</th> <th>±0.05</th> <th>±0.1</th> <th>F-2</th> <th>MS</th> <th>MS</th> <th>F-2</th> <th>MS</th> </tr> <tr> <th>6 - 30</th> <th>±0.1</th> <th>±0.2</th> <th>F-3</th> <th>MS</th> <th>MS</th> <th>F-3</th> <th>MS</th> </tr> <tr> <th>30 - 120</th> <th>±0.15</th> <th>±0.3</th> <th>F-4</th> <th>MS</th> <th>MS</th> <th>F-4</th> <th>MS</th> </tr> <tr> <th>120 - 400</th> <th>±0.2</th> <th>±0.5</th> <th>F-5</th> <th>MS</th> <th>MS</th> <th>F-5</th> <th>MS</th> </tr> <tr> <th>400 - 1000</th> <th>±0.3</th> <th>±0.8</th> <th>F-6</th> <th>MS</th> <th>MS</th> <th>F-6</th> <th>MS</th> </tr> </thead> </table>		GENERAL TOLERANCE		CHAMFER	0.5	ROUND	0.5	UNIT	mm	MACHINING WORKING	DIE CASTING	INJECTION MOLDING		PRESS WORKING				FINISH	PRECISION	GRADE	FINISH	PRECISION	GRADE			0.5 - 6	±0.05	±0.1	F-2	MS	MS	F-2	MS	6 - 30	±0.1	±0.2	F-3	MS	MS	F-3	MS	30 - 120	±0.15	±0.3	F-4	MS	MS	F-4	MS	120 - 400	±0.2	±0.5	F-5	MS	MS	F-5	MS	400 - 1000	±0.3	±0.8	F-6	MS	MS	F-6	MS
GENERAL TOLERANCE		CHAMFER	0.5	ROUND	0.5	UNIT	mm																																																										
MACHINING WORKING	DIE CASTING	INJECTION MOLDING		PRESS WORKING																																																													
FINISH	PRECISION	GRADE	FINISH	PRECISION	GRADE																																																												
0.5 - 6	±0.05	±0.1	F-2	MS	MS	F-2	MS																																																										
6 - 30	±0.1	±0.2	F-3	MS	MS	F-3	MS																																																										
30 - 120	±0.15	±0.3	F-4	MS	MS	F-4	MS																																																										
120 - 400	±0.2	±0.5	F-5	MS	MS	F-5	MS																																																										
400 - 1000	±0.3	±0.8	F-6	MS	MS	F-6	MS																																																										
APPROVED BY	CHECKED BY	DRAWN BY	<table border="1"> <thead> <tr> <th colspan="3">PRODUCT GENERAL TOLERANCE</th> </tr> <tr> <th>CASTER HEIGHT</th> <th>WHEEL OUTER DIAMETER</th> <th>WHEEL HUB WIDTH</th> </tr> </thead> <tbody> <tr> <td>±0.1</td> <td>±0.1</td> <td>±0.1</td> </tr> <tr> <td>±0.1</td> <td>±0.1</td> <td>±0.1</td> </tr> <tr> <td>±0.1</td> <td>±0.1</td> <td>±0.1</td> </tr> </tbody> </table>					PRODUCT GENERAL TOLERANCE			CASTER HEIGHT	WHEEL OUTER DIAMETER	WHEEL HUB WIDTH	±0.1	±0.1	±0.1	±0.1	±0.1	±0.1	±0.1	±0.1	±0.1																																											
PRODUCT GENERAL TOLERANCE																																																																	
CASTER HEIGHT	WHEEL OUTER DIAMETER	WHEEL HUB WIDTH																																																															
±0.1	±0.1	±0.1																																																															
±0.1	±0.1	±0.1																																																															
±0.1	±0.1	±0.1																																																															
O.C.K	J.Y.H	K.S.J																																																															

FOOT MASTER®		FOOMA®		G-DOK IND.	
SERIES NAME	SPLM-SERIES	DATE	2025.07.18	GSN NO.	39152-211111
PRODUCT NAME	SPLM-75-BSS-NYP-PM12	SCALE	1/2	DWG. NO.	39152-211111
PART NAME	ASSEMBLY	WEIGHT	---	REVISION	SIZE A3
GENERAL TOLERANCE		B	ANGLE		⊕

FOOT MASTER G-DOK IND.

REV. NO.	DATE	DESCRIPTION	APP'D	REMARKS
△	-	-	-	-

0

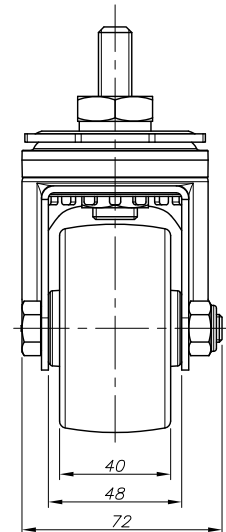
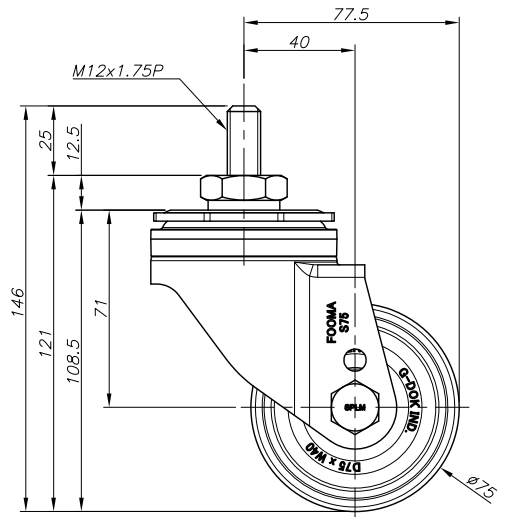
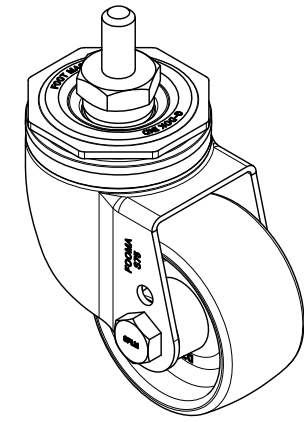
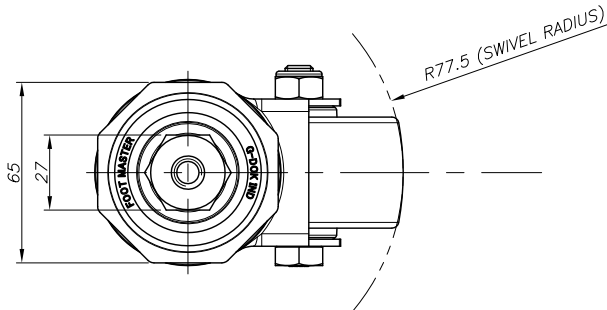

NOTE
 1) MATERIAL : STAINLESS

PROCESS	GENERAL TOLERANCE											
MATERIAL	MACHINING WORKING			DIE CASTINGS			INJECTION MOLDING			PRESS WORKING		
	ANGZ	PRECISION	GRADE	ANGZ	PRECISION	GRADE	ANGZ	PRECISION	GRADE	ANGZ	PRECISION	GRADE
	0.5 - 6	±0.05	±0.1	F-3	±0.1	±0.2	F-3	±0.1	±0.2	F-3	±0.1	±0.2
	6 - 30	±0.1	±0.2	F-3	±0.1	±0.2	F-3	±0.1	±0.2	F-3	±0.1	±0.2
	30 - 120	±0.15	±0.3	F-3	±0.1	±0.2	F-3	±0.1	±0.2	F-3	±0.1	±0.2
	120 - 400	±0.2	±0.5	F-3	±0.1	±0.2	F-3	±0.1	±0.2	F-3	±0.1	±0.2
	400 - 1000	±0.3	±0.8	F-3	±0.1	±0.2	F-3	±0.1	±0.2	F-3	±0.1	±0.2

APPROVED BY	CHECKED BY	DRAWN BY	PRODUCT GENERAL TOLERANCE		
			CASTER HEIGHT	WHEEL OUTER DIAMETER	WHEEL HUB WIDTH
O.C.K	J.Y.H	K.S.J	±0.1	±0.1	±0.1
			±0.1	±0.1	±0.1
			±0.1	±0.1	±0.1

FOOT MASTER®		FOOMA®		G-DOK IND.	
SERIES NAME	SPLM-SERIES	DATE	2025.07.18	GSN NO.	39142-211111
PRODUCT NAME	SPLM-75-ASS-NYP-PM12	SCALE	1/2	DWG. NO.	39142-211111
PART NAME	ASSEMBLY	WEIGHT	--	REVISION	SIZE A3
		GENERAL TOLERANCE	B	ANGLE	⊙

FOOT MASTER G-DOK IND.