

REV. NO.	DATE	DESCRIPTION	APP'D	REMARKS
▲	-	-	-	-

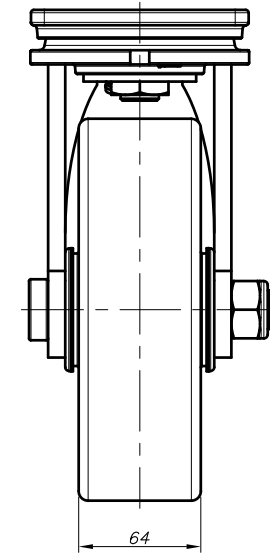
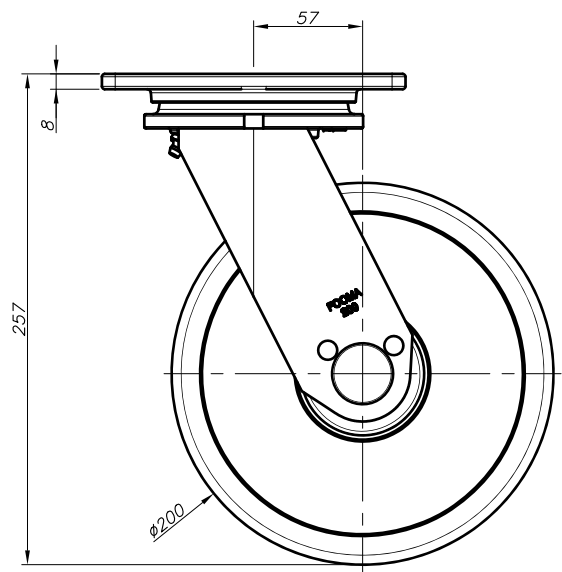
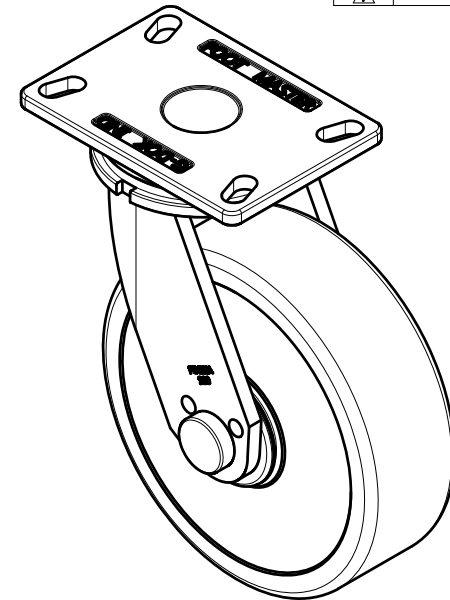
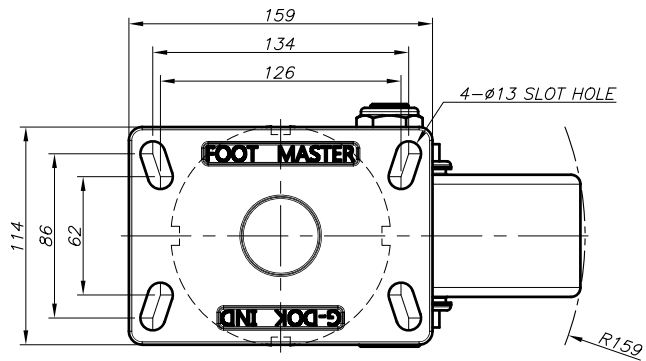

NOTE  
 ※ 1) --

PROCESS			GENERAL TOLERANCE															
MATERIAL			MACHINING WORKING				DIE CASTING				INJECTION MOLDING				PRESS WORKING			
			FINISH	PRECISION	GENERAL	FINISH	PRECISION	GENERAL	FINISH	PRECISION	GENERAL	FINISH	PRECISION	GENERAL	FINISH	PRECISION	GENERAL	
APPROVED BY	CHECKED BY	DRAWN BY	PRODUCT GENERAL TOLERANCE															
O.C.K	J.Y.H	S.D.W	CASTER HEIGHT	WHEEL OUTER DIAMETER	WHEEL HUB WIDTH													
			PRECISION	GENERAL	PRECISION	GENERAL	PRECISION	GENERAL										
			±0.05 (0.015mm)	±1% (0.15mm)	±0.05 (0.015mm)	±1% (0.15mm)	-1% (0.15mm)	-2% (0.3mm)										
			120 ~ 400	±0.2	±0.5	0.1	0.2	0.1	0.2	0.1	0.2	0.1	0.2	0.1	0.2	0.1	0.2	
			400 ~ 1000	±0.3	±0.8	0.2	0.5	0.1	0.3	0.1	0.3	0.1	0.3	0.1	0.3	0.1	0.3	

NO.	DESCRIPTION	UNIT	Q'TY	MATERIAL	WEIGHT	SPECIFICATION	REMARKS
--	--	--	--	--	--	--	--

FOOT MASTER®			FOOMA®			G-DOK IND.		
SERIES NAME	GF-SERIES	DATE	2023.08.21	GSN NO.	-			
PRODUCT NAME	GF-200-ASF-MCD	SCALE	N/S	DWG. NO.	-			
PART NAME	ASSEMBLY	WEIGHT	--	REVISION				
		GENERAL TOLERANCE	--	ANGLE	▲			

REV. NO.	DATE	DESCRIPTION	APP'D	REMARKS
▲	-	-	-	-

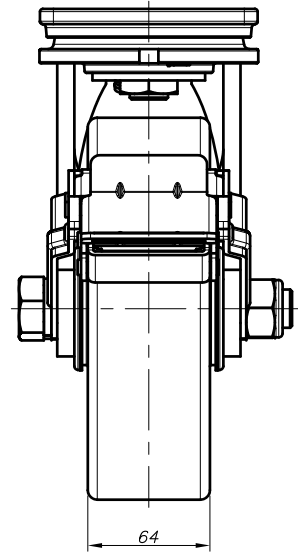
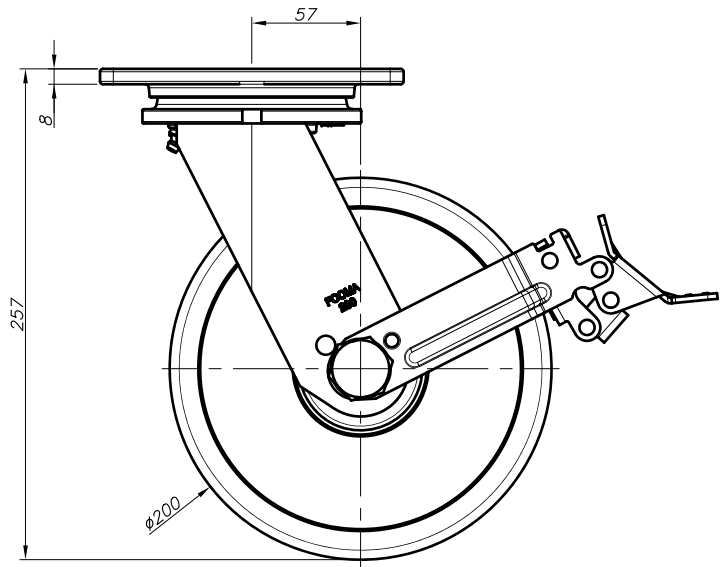
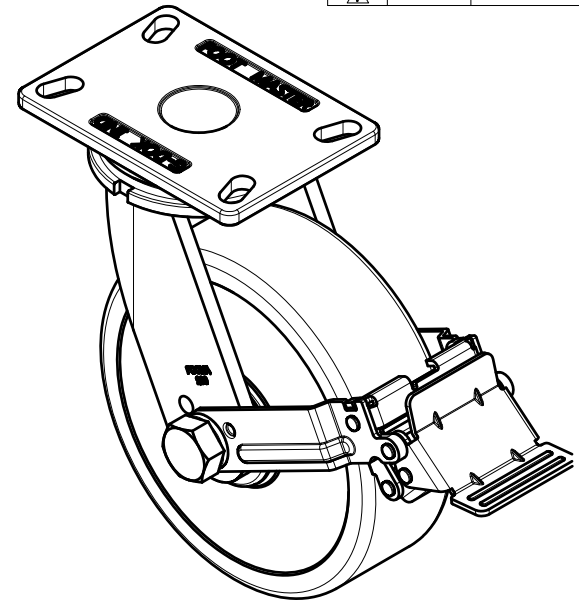
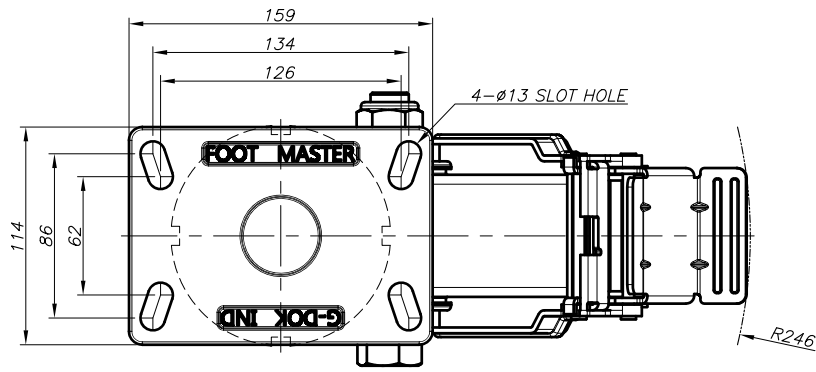

NOTE

※ 1) --

NO.	DESCRIPTION	UNIT	Q'TY	MATERIAL	WEIGHT	SPECIFICATION	REMARKS
--	--	--	--	--	--	--	--

PROCESS			GENERAL TOLERANCE															
MATERIAL			MACHINING WORKING				DIE CASTING				INJECTION MOLDING				PRESS WORKING			
APPROVED BY	CHECKED BY	DRAWN BY	MINUS	PRESION	GENERAL	MINUS	PRESION	GENERAL	MINUS	PRESION	GENERAL	MINUS	PRESION	GENERAL	MINUS	PRESION	GENERAL	
O.C.K	J.Y.H	S.D.W	0.5-6	±0.05	±0.1	0.5-30	±0.15	±0.3	0.5-30	±0.1	±0.2	0.5-30	±0.1	±0.2	0.5-30	±0.1	±0.2	
			30-120	±0.2	±0.5	120-400	±0.3	±0.8	400-1000	±0.5	±1.0	120-400	±0.4	±1.0	400-1000	±0.6	±1.5	

FOOT MASTER®		FOOMA®		G-DOK IND.	
SERIES NAME	GF-SERIES	DATE	2023.08.21	GSN NO.	-
PRODUCT NAME	GF-200-BSF-MCD	SCALE	N/S	DWG. NO.	-
PART NAME	ASSEMBLY	WEIGHT	--	REVISION	
		GENERAL TOLERANCE	--	ANGLE	▲

REV. NO.	DATE	DESCRIPTION	APP'D	REMARKS
▲	-	-	-	-

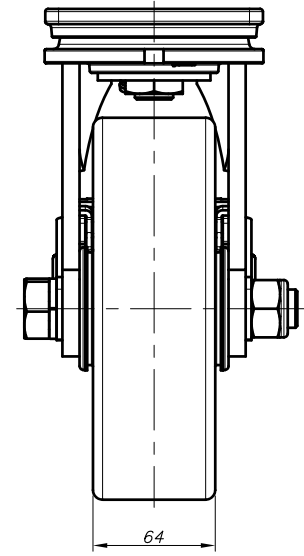
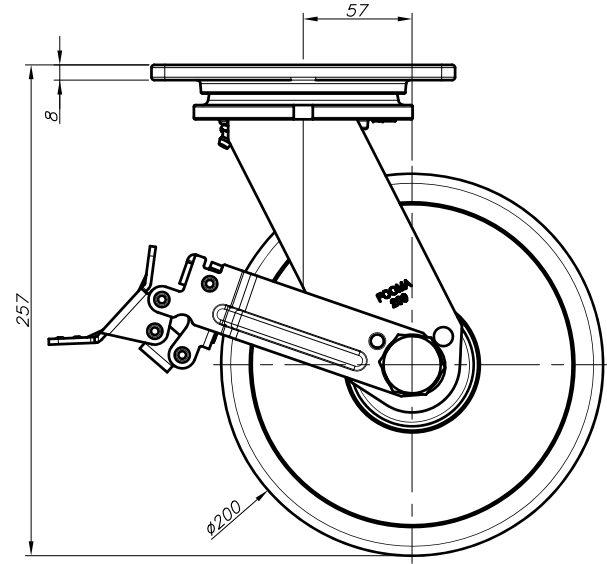
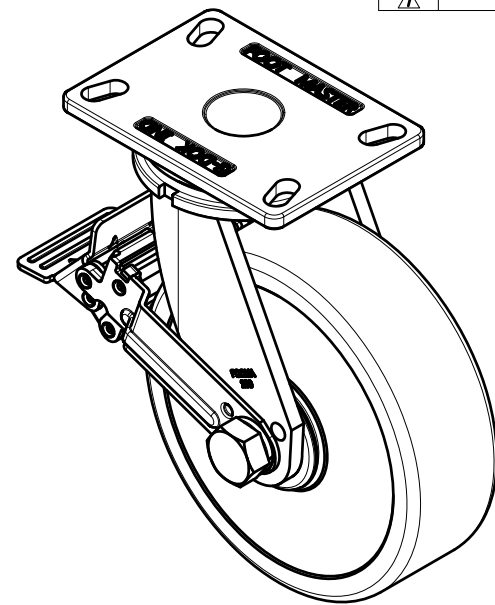
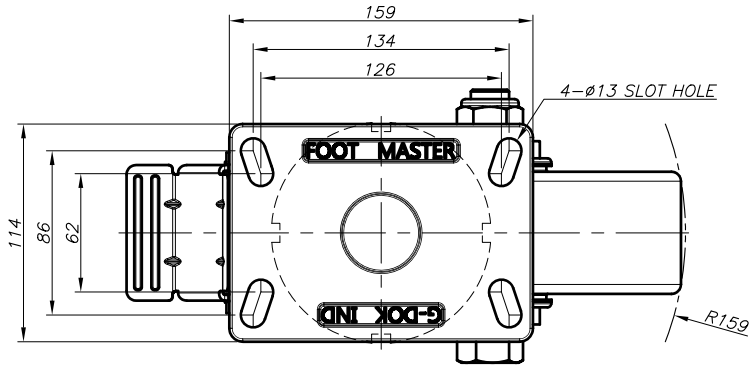
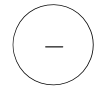

NOTE

※ 1) --

NO.	DESCRIPTION	UNIT	Q'TY	MATERIAL	WEIGHT	SPECIFICATION	REMARKS
--	--	--	--	--	--	--	--

PROCESS	MATERIAL	APPROVED BY	CHECKED BY	DRAWN BY	GENERAL TOLERANCE																													
---	---	O.C.K	J.Y.H	S.D.W	PRODUCT GENERAL TOLERANCE																													
					CASTER HEIGHT			WHEEL OUTER DIAMETER			WHEEL HUB WIDTH			MACHINING WORKING			DIE CASTING			INJECTION MOLDING			PRESS WORKING											
					0.5 - 6	±0.05	±0.1	0.5 - 30	±0.1	±0.2	30 - 120	±0.15	±0.3	0.5 - 6	±0.05	±0.1	6 - 30	±0.1	±0.2	30 - 120	±0.15	±0.3	0.5 - 6	±0.05	±0.1	6 - 30	±0.1	±0.2	30 - 120	±0.15	±0.3			
					120 - 400	±0.2	±0.5	400 - 1000	±0.3	±0.8	120 - 400	±0.2	±0.5	400 - 1000	±0.3	±0.8	0.5 - 6	±0.05	±0.1	6 - 30	±0.1	±0.2	30 - 120	±0.15	±0.3	0.5 - 6	±0.05	±0.1	6 - 30	±0.1	±0.2	30 - 120	±0.15	±0.3

FOOT MASTER®		FOOMA®		G-DOK IND.	
SERIES NAME	GF-SERIES	DATE	2023.08.21	GSN NO.	-
PRODUCT NAME	GF-200-BSF-MCD-FRN	SCALE	N/S	DWG. NO.	-
PART NAME	ASSEMBLY	WEIGHT	--	REVISION	SIZE A3
		GENERAL TOLERANCE	--	ANGLE	▲

REV. NO.	DATE	DESCRIPTION	APP'D	REMARKS
▲	-	-	-	-

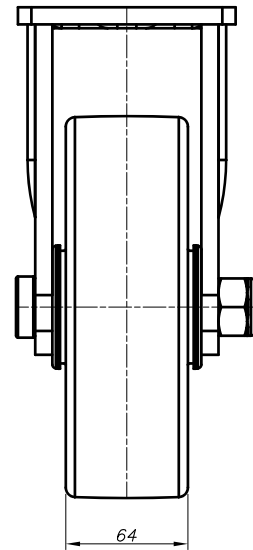
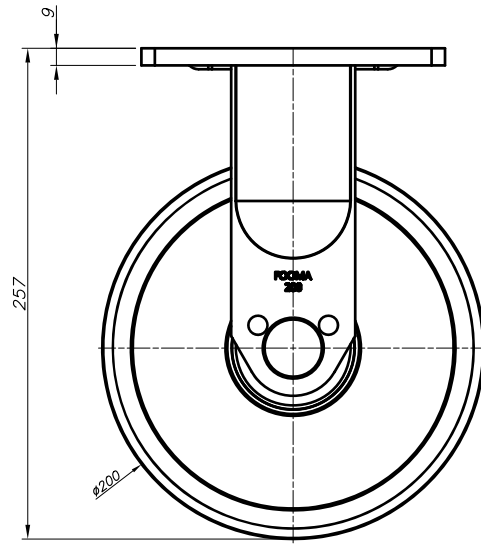
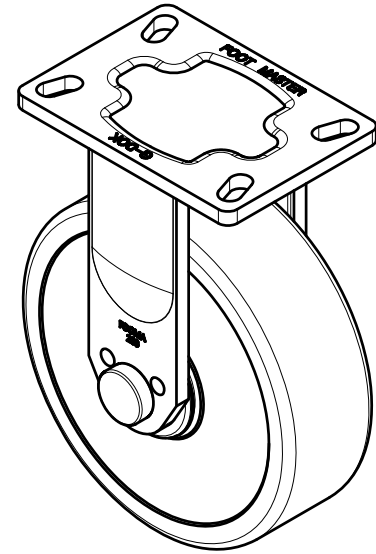
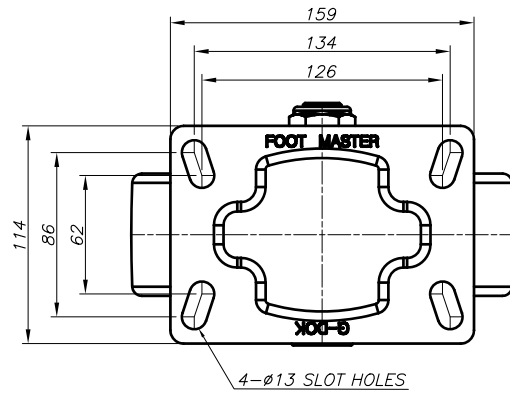

NOTE  
※ 1) --

PROCESS			GENERAL TOLERANCE																
MATERIAL			MACHINING WORKING				DIE CASTING				INJECTION MOLDING				PRESS WORKING				
APPROVED BY			DIMENSIONS		SURFACE		DIMENSIONS		SURFACE		DIMENSIONS		SURFACE		DIMENSIONS		SURFACE		
O.C.K	J.Y.H	S.D.W	0.5-6	±0.05	±0.1	0.5-6	±0.1	±0.1	0.5-6	±0.1	±0.1	0.5-6	±0.1	±0.1	0.5-6	±0.1	±0.1	0.5-6	±0.1
			6-30	±0.1	±0.2	30-120	±0.15	±0.3	30-120	±0.15	±0.3	30-120	±0.15	±0.3	30-120	±0.15	±0.3	30-120	±0.15
			120-400	±0.2	±0.5	400-1000	±0.3	±0.8	120-400	±0.2	±0.5	400-1000	±0.3	±0.8	120-400	±0.2	±0.5	400-1000	±0.3

FOOT MASTER®		FOOMA®		G-DOK IND.	
SERIES NAME	GF-SERIES	DATE	2023.08.21	GSN NO.	-
PRODUCT NAME	GF-200-ARF-MCD	SCALE	N/S	DWG. NO.	-
PART NAME	ASSEMBLY	WEIGHT	--	REVISION	
		GENERAL TOLERANCE	--	ANGLE	▲

FOOT MASTER G-DOK IND.

REV. NO.	DATE	DESCRIPTION	APP'D	REMARKS
▲	-	-	-	-

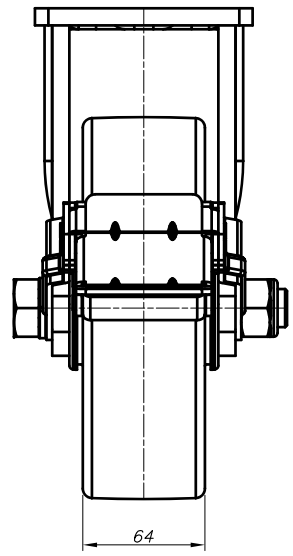
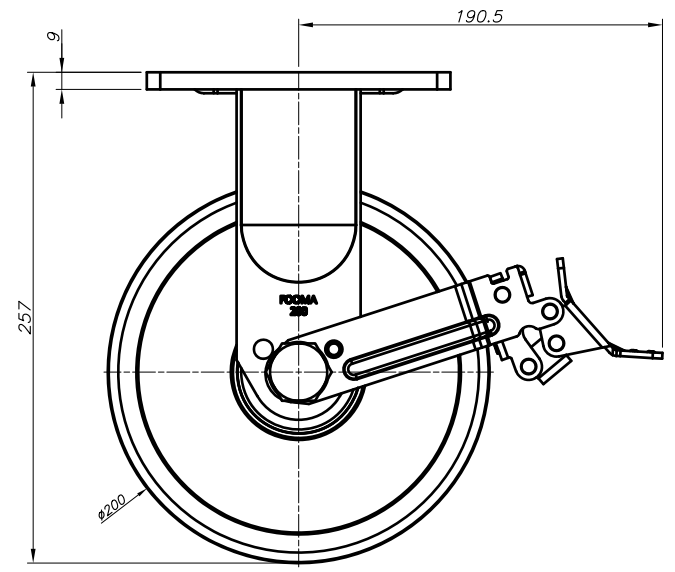
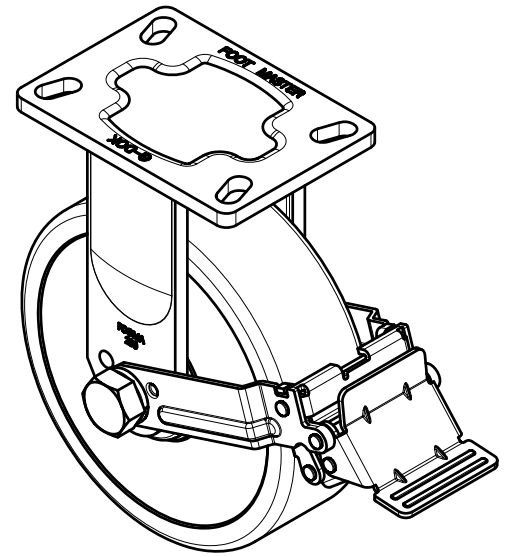
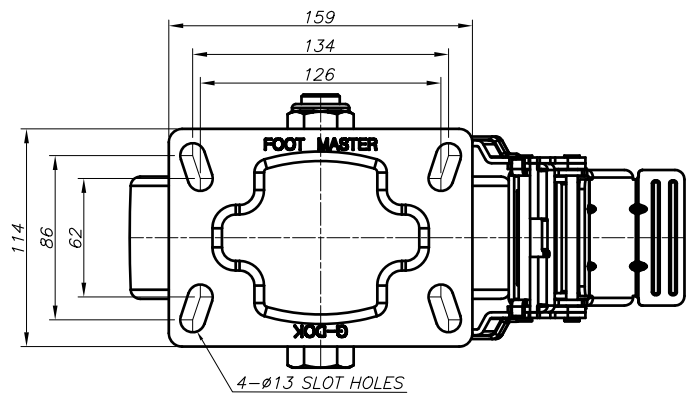

NOTE

※1) --

NO.	DESCRIPTION	UNIT	Q'TY	MATERIAL	WEIGHT	SPECIFICATION	REMARKS
--	--	--	--	--	--	--	--

PROCESS		MATERIAL		APPROVED BY		CHECKED BY		DRAWN BY	
---		---		O.C.K		J.Y.H		S.D.W	

GENERAL TOLERANCE											
MACHINING WORKING					DIE CASTING		INJECTION MOLDING			PRESS WORKING	
FINISH	PRECISION	GENERAL	FINISH	PRECISION	GENERAL	FINISH	PRECISION	GENERAL	FINISH	PRECISION	GENERAL
0.5 - 6	±0.05	±0.1	1-10	±0.1	±0.2	1-10	±0.1	±0.2	1-10	±0.1	±0.2
6 - 30	±0.1	±0.2	30 - 120	±0.15	±0.3	30 - 120	±0.15	±0.3	30 - 120	±0.15	±0.3
120 - 400	±0.2	±0.5	400 - 1000	±0.3	±0.8	120 - 400	±0.2	±0.5	400 - 1000	±0.3	±0.8

PRODUCT GENERAL TOLERANCE					
CASTER HEIGHT		WHEEL OUTER DIAMETER		WHEEL HUB WIDTH	
±0.5%	±1%	±0.5%	±1%	-1%	-2%
(MIN:0.5mm)	(MIN:1mm)	(MIN:0.5mm)	(MIN:1mm)	(MIN:0.5mm)	(MIN:1mm)

SERIES NAME		DATE		GSN NO.	
GF-SERIES		2023.08.21		-	
PRODUCT NAME		SCALE		DWG. NO.	
GF-200-BRF-MCD		N/S		-	
PART NAME		WEIGHT		REVISION	
ASSEMBLY		--		-	
GENERAL TOLERANCE		ANGLE		SIZE	
--		▲		A3	

FOOT MASTER G-DOK IND.